

DATE PLOTTED: 8/10/2011 TIME PLOTTED: 4:02:17 PM
 PATH: L:\P...works\10-008\08\Draws\Final Plans\Bridge Closure.dwg

SCALE: 1" = 1000'

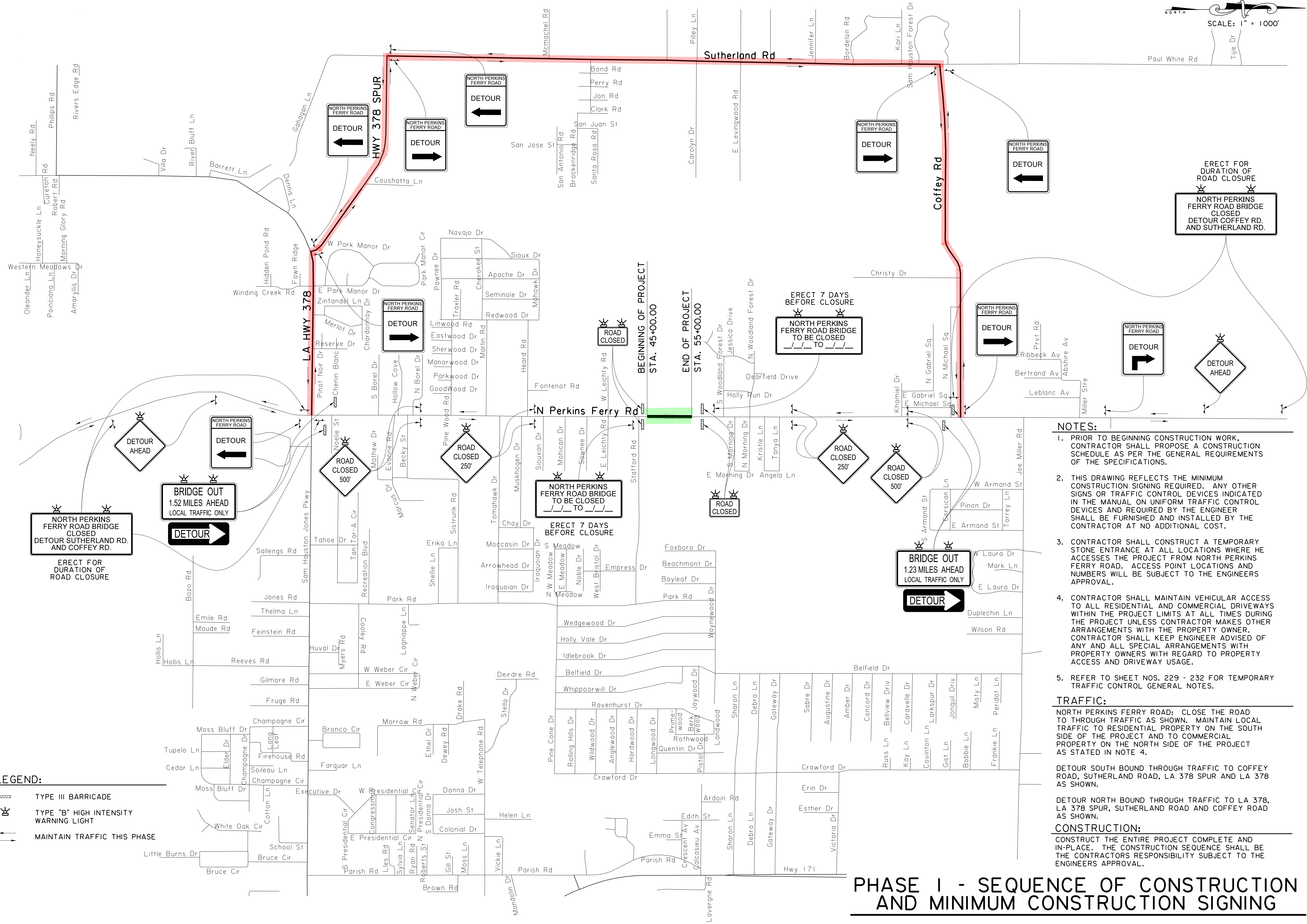

- NOTES:**
1. PRIOR TO BEGINNING CONSTRUCTION WORK, CONTRACTOR SHALL PROPOSE A CONSTRUCTION SCHEDULE AS PER THE GENERAL REQUIREMENTS OF THE SPECIFICATIONS.
 2. THIS DRAWING REFLECTS THE MINIMUM CONSTRUCTION SIGNING REQUIRED. ANY OTHER SIGNS OR TRAFFIC CONTROL DEVICES INDICATED IN THE MANUAL ON UNIFORM TRAFFIC CONTROL DEVICES AND REQUIRED BY THE ENGINEER SHALL BE FURNISHED AND INSTALLED BY THE CONTRACTOR AT NO ADDITIONAL COST.
 3. CONTRACTOR SHALL CONSTRUCT A TEMPORARY STONE ENTRANCE AT ALL LOCATIONS WHERE HE ACCESSES THE PROJECT FROM NORTH PERKINS FERRY ROAD. ACCESS POINT LOCATIONS AND NUMBERS WILL BE SUBJECT TO THE ENGINEERS APPROVAL.
 4. CONTRACTOR SHALL MAINTAIN VEHICULAR ACCESS TO ALL RESIDENTIAL AND COMMERCIAL DRIVEWAYS WITHIN THE PROJECT LIMITS AT ALL TIMES DURING THE PROJECT UNLESS CONTRACTOR MAKES OTHER ARRANGEMENTS WITH THE PROPERTY OWNER. CONTRACTOR SHALL KEEP ENGINEER ADVISED OF ANY AND ALL SPECIAL ARRANGEMENTS WITH PROPERTY OWNERS WITH REGARD TO PROPERTY ACCESS AND DRIVEWAY USAGE.
 5. REFER TO SHEET NOS. 229 - 232 FOR TEMPORARY TRAFFIC CONTROL GENERAL NOTES.

TRAFFIC:
 NORTH PERKINS FERRY ROAD: CLOSE THE ROAD TO THROUGH TRAFFIC AS SHOWN. MAINTAIN LOCAL TRAFFIC TO RESIDENTIAL PROPERTY ON THE SOUTH SIDE OF THE PROJECT AND TO COMMERCIAL PROPERTY ON THE NORTH SIDE OF THE PROJECT AS STATED IN NOTE 4.

DETOUR SOUTH BOUND THROUGH TRAFFIC TO COFFEY ROAD, SUTHERLAND ROAD, LA 378 SPUR AND LA 378 AS SHOWN.

DETOUR NORTH BOUND THROUGH TRAFFIC TO LA 378, LA 378 SPUR, SUTHERLAND ROAD AND COFFEY ROAD AS SHOWN.

CONSTRUCTION:
 CONSTRUCT THE ENTIRE PROJECT COMPLETE AND IN-PLACE. THE CONSTRUCTION SEQUENCE SHALL BE THE CONTRACTORS RESPONSIBILITY SUBJECT TO THE ENGINEERS APPROVAL.

LEGEND:

- TYPE III BARRICADE
- TYPE "B" HIGH INTENSITY WARNING LIGHT
- MAINTAIN TRAFFIC THIS PHASE

DESIGNED: L. LANGON	CHECKED: G. BRUNO
DESIGNED: G. BRUNO	CHECKED: L. LANGON
DATE: AUGUST, 2011	PROJECT NO. 10-008
REV. NO. 0	SHEET NO. 10

ARMAND DITCH PROJECT
 PHASE 1
 (NORTH PERKINS FERRY ROAD BRIDGE)

GRAVITY DRAINAGE
 DISTRICT NO. 8, WARD 1

LANCON ENGINEERS INC.
 CIVIL AND CONSULTING ENGINEERS
 1000 WESTLAKE LA 70086
 REG. NO. 243106
 PROFESSIONAL ENGINEER
 HARRY LEE LANGON, JR.

PHASE I - SEQUENCE OF CONSTRUCTION AND MINIMUM CONSTRUCTION SIGNING